

This document is confidential. The copyright is vested in Combimac B.V. Emmen, The Netherlands. All rights reserved. Neither the whole nor any part of this document may be disclosed to any third party or reproduced, stored in any retrieval system or transmitted in any form or by any means (electronic, mechanical, reprographic, recording or otherwise) without the prior written consent of the copyright owner.

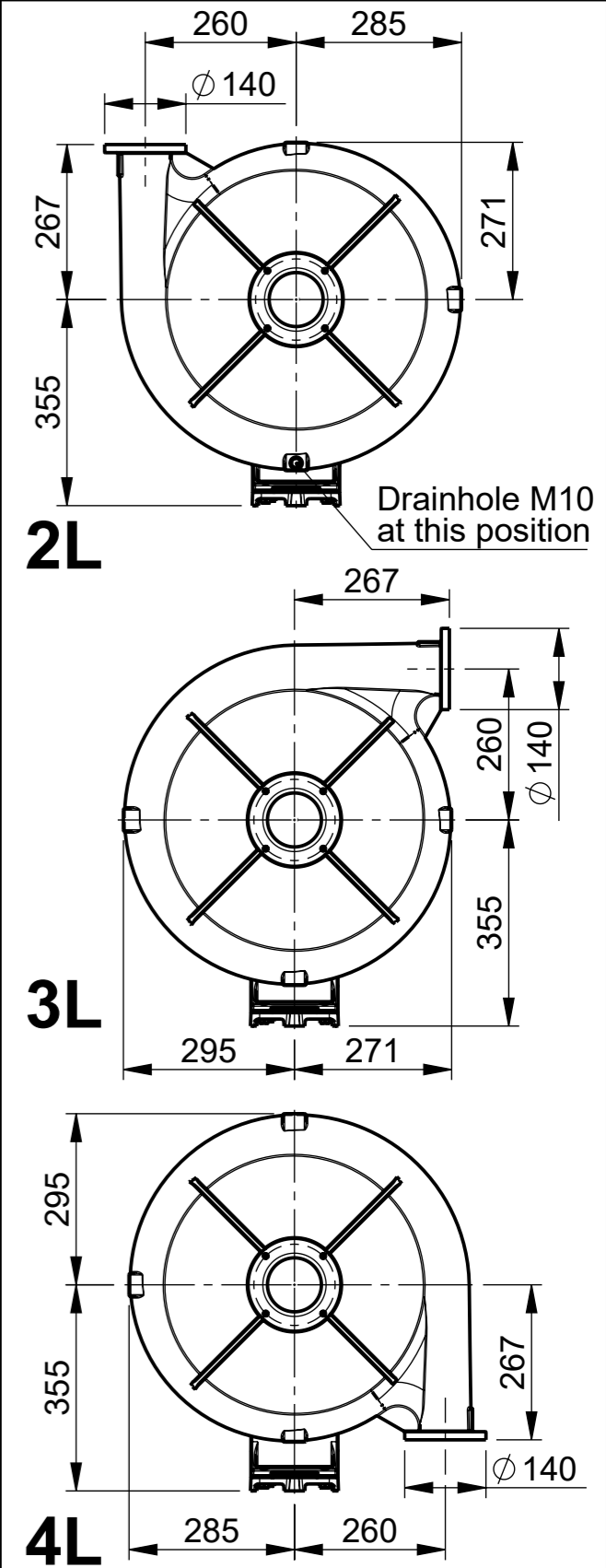
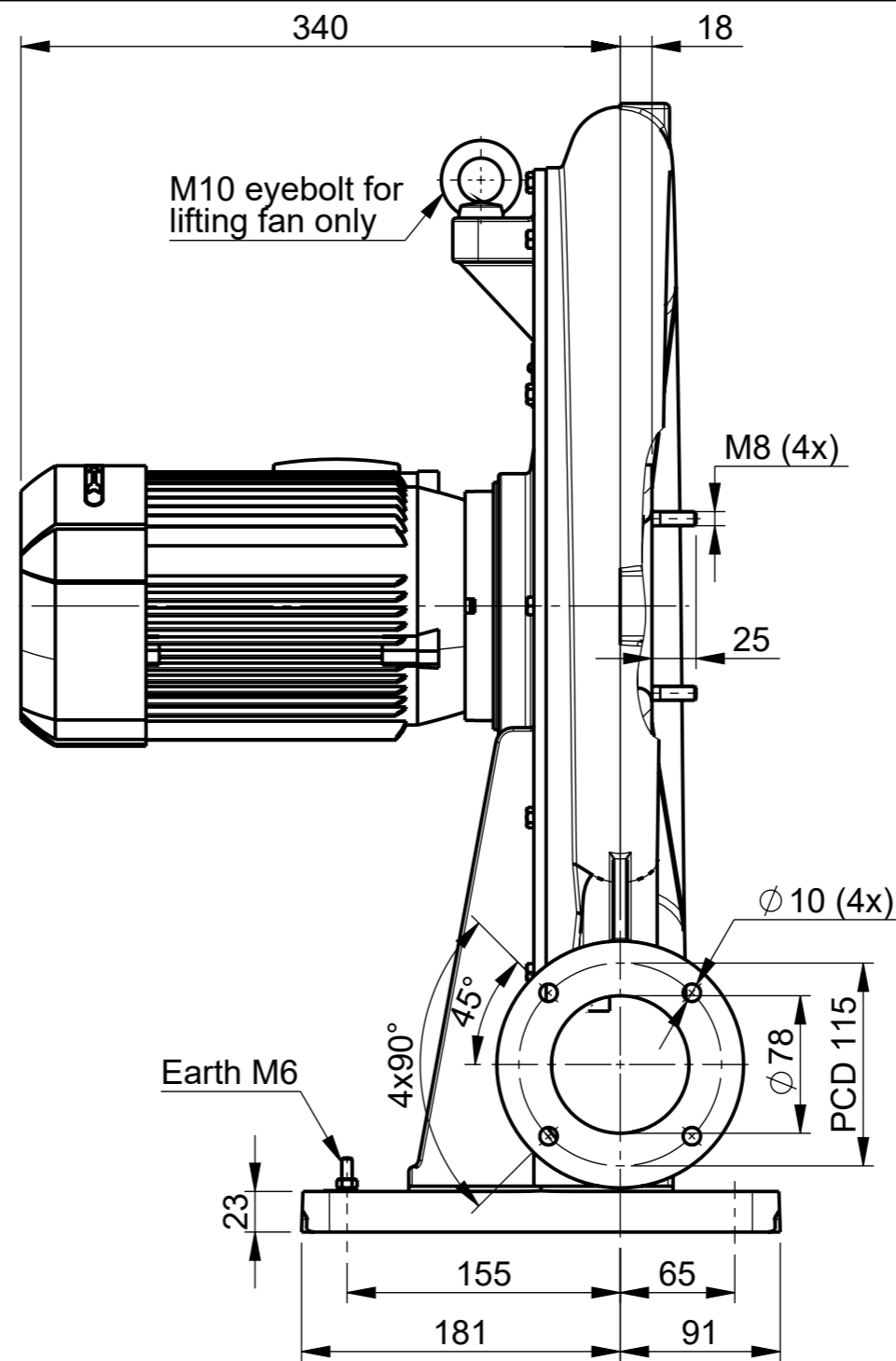
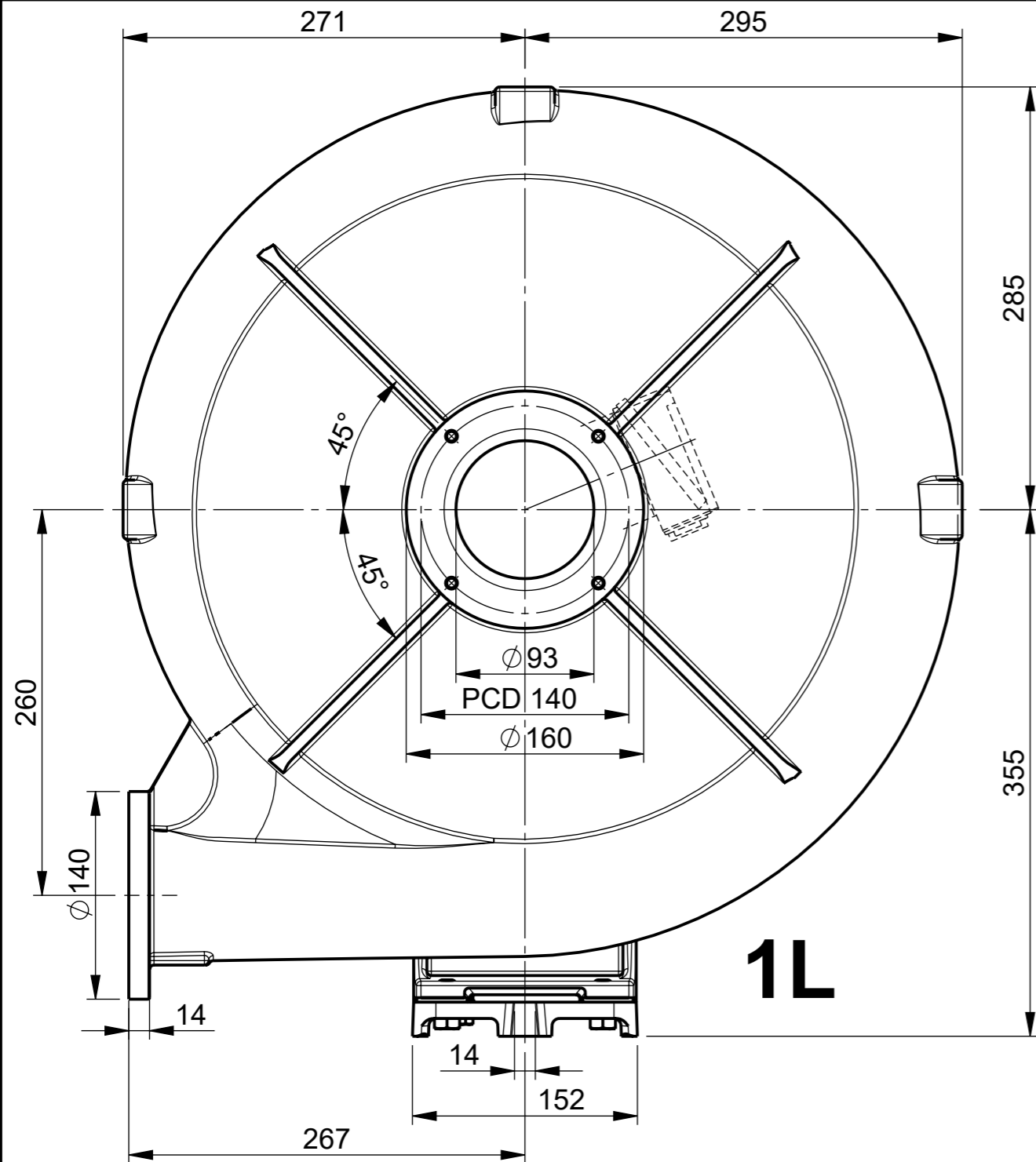

Fan type : 51DZK475-M10-2L/R2J1
 Part nr. : 847.563
 Fan speed : Approx. 2900 rpm
 Fan Ex class : Ex II 3G/3G Ex h IIB T3 Gc/Gc
 Mass : ± 73 kg
 Remarks : Shaft sealed by lipseal
 : Impeller made from stainless steel 316

Motor type : 6RE80-02
 Motor power : 0.75 kW
 Motor supply : 230/400V-50Hz-3ph.
 Motor frame size : IEC80 - B14a
 Motor Ex class : Ex II 2G Ex eb IIC T3 Gb
 Protection : IP55 - Cl. F
 Remarks :

01	-	12-01-2021	Redrawn in 3D. Motor length 340 was 321.5	AB
00				
ISSUE	QTY	DATE	DESCRIPTION	NAME
	PROJECTION	ROUGHNESS SYMBOLS ACC. ISO 1302	GENERAL TOLERANCES ACC. ISO 2768-M	GEOMETRIC TOLERANCE SYMBOLS ACC. ISO 1101
	Special electric motors and fans	Outline drawing of COMBIMAC centrifugal fan Type 51DZK475-M10-2L/R2J1		847.563
		SCALE 1:4	DIMS IN mm	C.003.302
		DRAWN 17-03-2006 HvK	CHECKED	